

Memory Module Specifications

KSM26SED8/32HC

32GB 2Rx8 4G x 72-Bit PC4-2666

CL19 260-Pin ECC SODIMM

DESCRIPTION

Kingston's KSM26SED8/32HA is a 4G x 72-bit (32GB) DDR4-2666 CL19 SDRAM (Synchronous DRAM) w/ parity, 2Rx8, ECC, memory module, based on eighteen 2G x 8-bit FBGA components. The SPD is programmed to JEDEC standard latency DDR4-2666 timing of 19-19-19 at 1.2V. Each 260-pin SODIMM uses gold contact fingers. The electrical and mechanical specifications are as follows:

FEATURES

- Power Supply: VDD = 1.2V
- VDDQ = 1.2V
- VPP = 2.5V
- VDDSPD = 2.20V to 3.60V
- Functionality and operations comply with the DDR4 SDRAM datasheet
- 16 internal banks
- Bank Grouping is applied, and CAS to CAS latency (tCCD_L, tCCD_S) for the banks in the same or different bank group accesses are available
- Data transfer rates: PC4-2666, PC4-2400, PC4-2133, PC4-1866, PC4-1600
- Bi-Directional Differential Data Strobe
- 8 bit pre-fetch
- Burst Length (BL) switch on-the-fly BL8 or BC4(Burst Chop)
- Supports ECC error correction and detection
- On-Die Termination (ODT)
- Temperature sensor with integrated SPD
- This product is in compliance with the RoHS directive.
- Per DRAM Addressability is supported
- Internal Vref DQ level generation is available
- Write CRC is supported at all speed grades
- CA parity (Command/Address Parity) mode is supported
- RoHS Compliant and Halogen-Free

SPECIFICATIONS

CL(IDD)	19 cycles
Row Cycle Time (tRCmin)	45.75ns(min.)
Refresh to Active/Refresh Command Time (tRFCmin)	350ns(min.)
Row Active Time (tRASmin)	32ns(min.)
Maximum Operating Power	*
UL Rating	94 V - 0
Operating Temperature	0° C to +85° C
Storage Temperature	-55° C to +100° C

*See IDD Specifications (page 2)

Module Assembly

DRAM: HYNIX (C-DIE)

Continued >>

IDD Specifications

IDD		unit
Symbol	2666	
IDD0	592	mA
IDD0A	592	mA
IDD1	653	mA
IDD1A	681	mA
IDD2N	502	mA
IDD2NA	502	mA
IDD2NT	563	mA
IDD2NL	347	mA
IDD2NG	501	mA
IDD2ND	454	mA
IDD2NP	510	mA
IDD2P	342	mA
IDD2Q	467	mA
IDD3N	943	mA
IDD3NA	940	mA
IDD3P	803	mA
IDD4R	1275	mA
IDD4RA	1286	mA
IDD4RB	1281	mA
IDD4W	1234	mA
IDD4WA	1264	mA
IDD4WB	1174	mA
IDD4WC	1224	mA
IDD4WP	1333	mA
IDD5B	4984	mA
IDD5F2	3466	mA
IDD5F4	2766	mA
IDD6N	679	mA
IDD6E	1083	mA
IDD6R	290	mA
IDD6A	1151	mA
IDD7	1510	mA
IDD8	179	mA

IPP		unit
Symbol	2666	
IPP0	29	mA
IPP1	33	mA
IPP2N	16	mA
IPP2P	16	mA
IPP3N	19	mA
IPP3P	19	mA
IPP4R	53	mA
IPP4W	53	mA
IPP5B	491	mA
IPP5F2	323	mA
IPP5F4	269	mA
IPP6N	65	mA
IPP6E	115	mA
IPP6R	28	mA
IPP6A	101	mA
IPP7	139	mA
IPP8	16	mA

MODULE DIMENSIONS

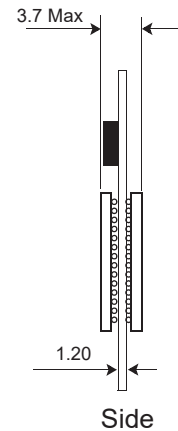
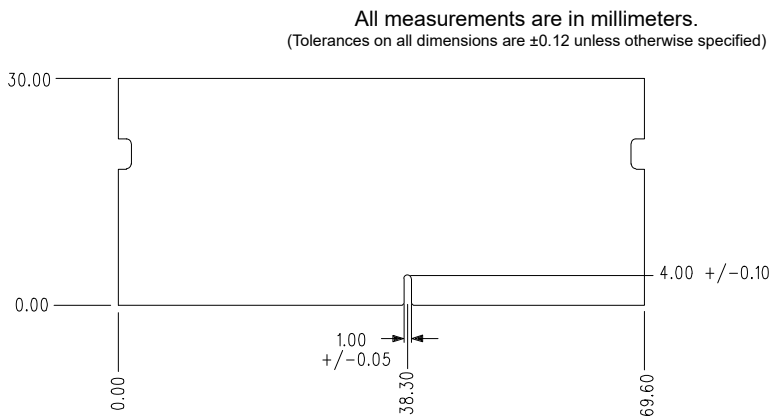
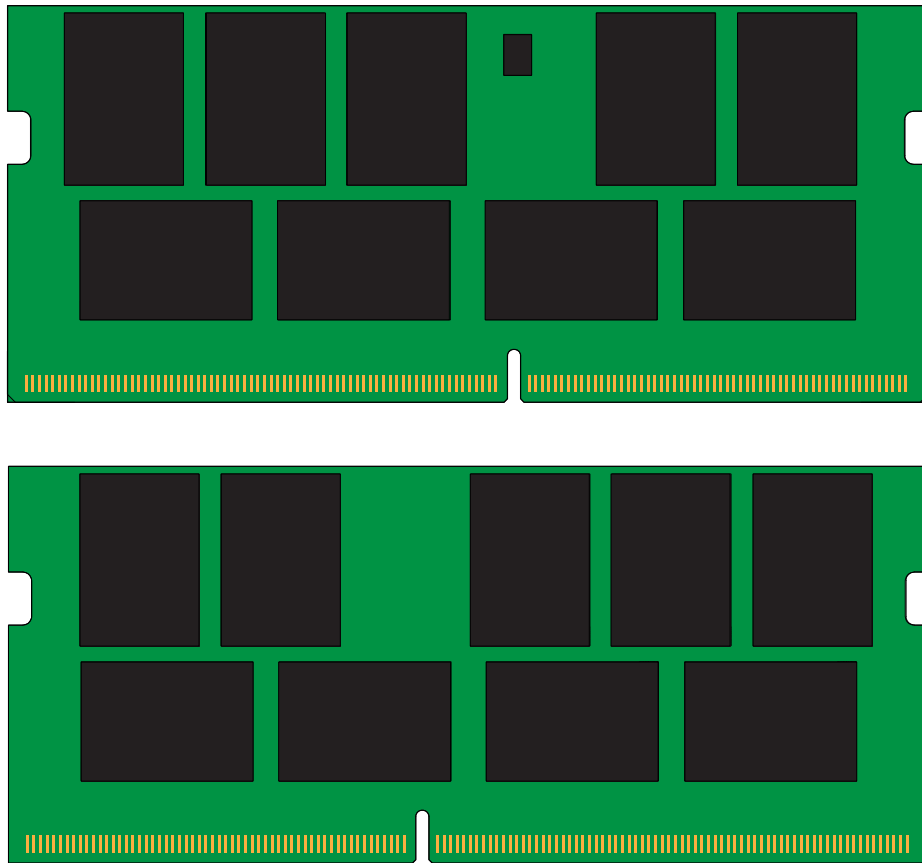

The product images shown are for illustration purposes only and may not be an exact representation of the product. Kingston reserves the right to change any information at anytime without notice.