

# Memory Module Specifications

## KSM26RS4/16HCI

16GB 1Rx4 2G x 72-Bit PC4-2666

CL19 Registered w/Parity 288-Pin DIMM

### DESCRIPTION

Kingston's KSM26RS4/16HCI is a 2G x 72-bit (16GB) DDR4-2666 CL19 SDRAM (Synchronous DRAM) registered w/ parity, 1Rx4, ECC, memory module, based on eighteen 2G x 4-bit FBGA components. The SPD is programmed to JEDEC standard latency DDR4-2666 timing of 19-19-19 at 1.2V. Each 288-pin DIMM uses gold contact fingers. The electrical and mechanical specifications are as follows:

### FEATURES

- Power Supply: VDD = 1.2V
- VDDQ = 1.2V
- VPP = 2.5V
- VDDSPD = 2.41V to 2.75V
- Functionality and operations comply with the DDR4 SDRAM datasheet
- 16 internal banks
- Bank Grouping is applied, and CAS to CAS latency (tCCD\_L, tCCD\_S) for the banks in the same or different bank group accesses are available
- Data transfer rates: PC4-2666, PC4-2400, PC4-2133, PC4-1866, PC4-1600
- Bi-Directional Differential Data Strobe
- 8 bit pre-fetch
- Burst Length (BL) switch on-the-fly BL8 or BC4(Burst Chop)
- Supports ECC error correction and detection
- On-Die Termination (ODT)
- Temperature sensor with integrated SPD
- This product is in compliance with the RoHS directive.
- Per DRAM Addressability is supported
- Internal Vref DQ level generation is available
- Write CRC is supported at all speed grades
- CA parity (Command/Address Parity) mode is supported

### SPECIFICATIONS

CL(IDD)	19 cycles
Row Cycle Time (tRCmin)	46.25ns(min.)
Refresh to Active/Refresh Command Time (tRFCmin)	350ns(min.)
Row Active Time (tRASmin)	32ns(min.)
Maximum Operating Power	*
UL Rating	94 V - 0
Operating Temperature	0° C to +85° C
Storage Temperature	-55° C to +100° C

\* See IDD Table (page 2)

### Module Assembly

**DRAM:** HYNIX (C-DIE)

**RCD:** IDT

Continued >>

## IDD Specifications

IDD		unit
Symbol	2666	
IDD0	1165	mA
IDD0A	1183	mA
IDD1	1353	mA
IDD1A	1371	mA
IDD2N	1003	mA
IDD2NA	1003	mA
IDD2NT	1093	mA
IDD2NL	877	mA
IDD2NG	1003	mA
IDD2ND	985	mA
IDD2NP	1003	mA
IDD2P	673	mA
IDD2Q	949	mA
IDD3N	1183	mA
IDD3NA	1183	mA
IDD3P	871	mA
IDD4R	2235	mA
IDD4RA	2325	mA
IDD4RB	543	mA
IDD4W	2199	mA
IDD4WA	2271	mA
IDD4WB	543	mA
IDD4WC	2199	mA
IDD4WP	2505	mA
IDD5B	4045	mA
IDD5F2	3091	mA
IDD5F4	2821	mA
IDD6N	400	mA
IDD6E	526	mA
IDD6R	274	mA
IDD6A	526	mA
IDD7	3981	mA
IDD8	238	mA

IPP		unit
Symbol	2666	
IPP0	99	mA
IPP1	117	mA
IPP2N	58	mA
IPP2P	58	mA
IPP3N	288	mA
IPP3P	288	mA
IPP4R	342	mA
IPP4W	342	mA
IPP5B	1134	mA
IPP5F2	738	mA
IPP5F4	630	mA
IPP6N	90	mA
IPP6E	126	mA
IPP6R	74	mA
IPP6A	126	mA
IPP7	468	mA
IPP8	58	mA

## MODULE DIMENSIONS

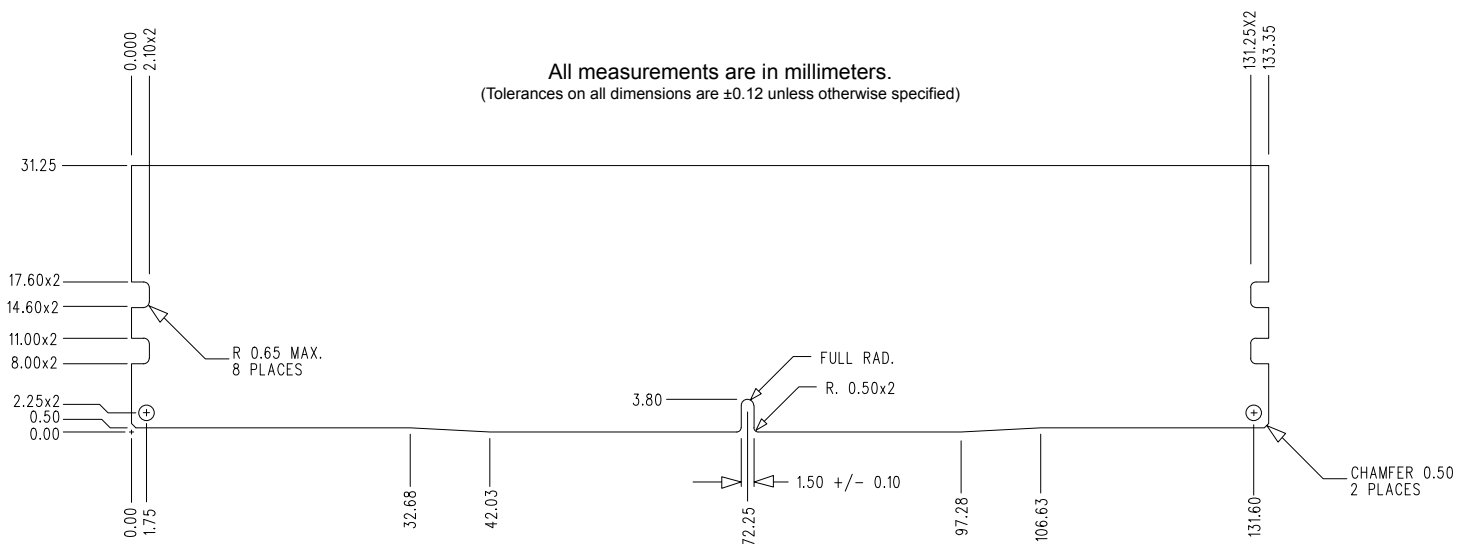
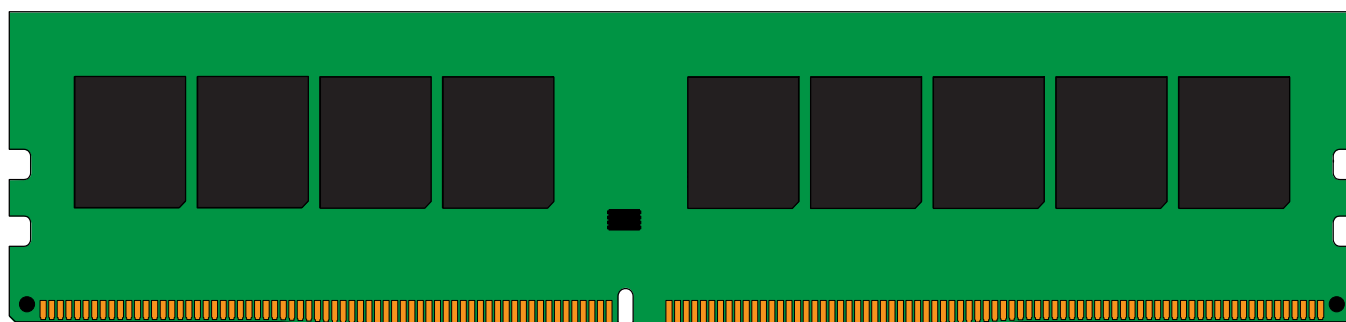
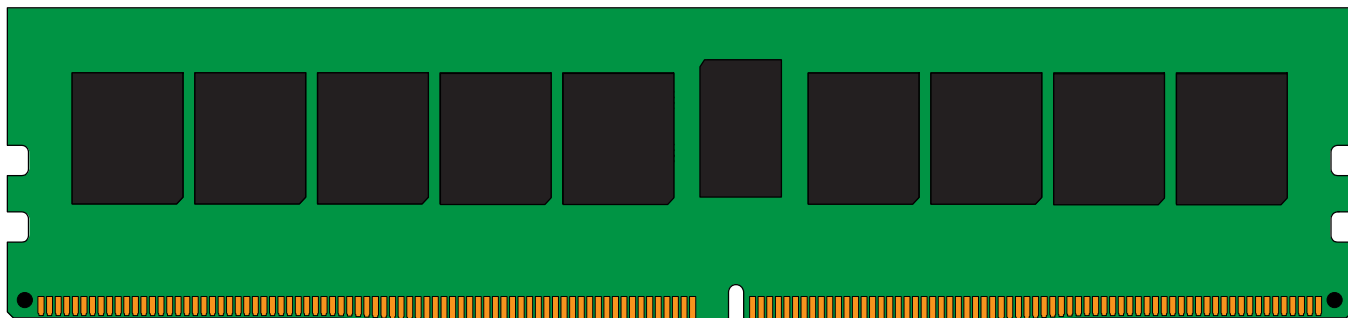

The product images shown are for illustration purposes only and may not be an exact representation of the product. Kingston reserves the right to change any information at anytime without notice.