

Memory Module Specifications

KSM26LQ4/64HCI

64GB 4Rx4 8G x 72-Bit PC4-2666

CL19 Load Reduced w/Parity 288-Pin DIMM

DESCRIPTION

Kingston's KSM26LQ4/64HCI is a 8G x 72-bit (64GB) DDR4-2666 CL19 SDRAM (Synchronous DRAM) load reduced w/ parity, 4Rx4, ECC, memory module, based on thirty-six 4G x 4-bit DDP FBGA components. The SPD is programmed to JEDEC standard latency DDR4-2666 timing of 19-19-19 at 1.2V. Each 288-pin DIMM uses gold contact fingers. The electrical and mechanical specifications are as follows:

FEATURES

- Power Supply: VDD = 1.2V
- VDDQ = 1.2V
- VPP = 2.5V
- VDDSPD = 2.41V to 2.75V
- Functionality and operations comply with the DDR4 SDRAM datasheet
- 16 internal banks
- Bank Grouping is applied, and CAS to CAS latency (tCCD_L, tCCD_S) for the banks in the same or different bank group accesses are available
- Data transfer rates: PC4-2666, PC4-2400, PC4-2133, PC4-1866, PC4-1600
- Bi-Directional Differential Data Strobe
- 8 bit pre-fetch
- Burst Length (BL) switch on-the-fly BL8 or BC4(Burst Chop)
- Supports ECC error correction and detection
- On-Die Termination (ODT)
- Temperature sensor with integrated SPD
- This product is in compliance with the RoHS directive.
- Per DRAM Addressability is supported
- Internal Vref DQ level generation is available
- Write CRC is supported at all speed grades
- CA parity (Command/Address Parity) mode is supported

SPECIFICATIONS

CL(IDD)	19 cycles
Row Cycle Time (tRCmin)	46.25ns(min.)
Refresh to Active/Refresh Command Time (tRFCmin)	350ns(min.)
Row Active Time (tRASmin)	32ns(min.)
Maximum Operating Power	*
UL Rating	94 V - 0
Operating Temperature	0° C to +85° C
Storage Temperature	-55° C to +100° C

* See IDD Table (page 2)

Module Assembly

DRAM: HYNIX (C-DIE)

RCD: IDT

Continued >>

IDD Specifications

IDD		unit
Symbol	2666	
IDD0	4391	mA
IDD0A	4409	mA
IDD1	4435	mA
IDD1A	4453	mA
IDD2N	4229	mA
IDD2NA	4229	mA
IDD2NT	4589	mA
IDD2NL	3725	mA
IDD2NG	4229	mA
IDD2ND	4157	mA
IDD2NP	4229	mA
IDD2P	3454	mA
IDD2Q	4013	mA
IDD3N	4949	mA
IDD3NA	4949	mA
IDD3P	4246	mA
IDD4R	5364	mA
IDD4RA	5454	mA
IDD4RB	5418	mA
IDD4W	5401	mA
IDD4WA	5473	mA
IDD4WB	5203	mA
IDD4WC	5401	mA
IDD4WP	5707	mA
IDD5B	7775	mA
IDD5F2	6767	mA
IDD5F4	6425	mA
IDD6N	2112	mA
IDD6E	2616	mA
IDD6R	1392	mA
IDD6A	2616	mA
IDD7	7110	mA
IDD8	1176	mA

IPP		unit
Symbol	2666	
IPP0	272	mA
IPP1	290	mA
IPP2N	230	mA
IPP2P	230	mA
IPP3N	1152	mA
IPP3P	1152	mA
IPP4R	515	mA
IPP4W	515	mA
IPP5B	1523	mA
IPP5F2	1073	mA
IPP5F4	929	mA
IPP6N	418	mA
IPP6E	562	mA
IPP6R	338	mA
IPP6A	562	mA
IPP7	641	mA
IPP8	230	mA

MODULE DIMENSIONS

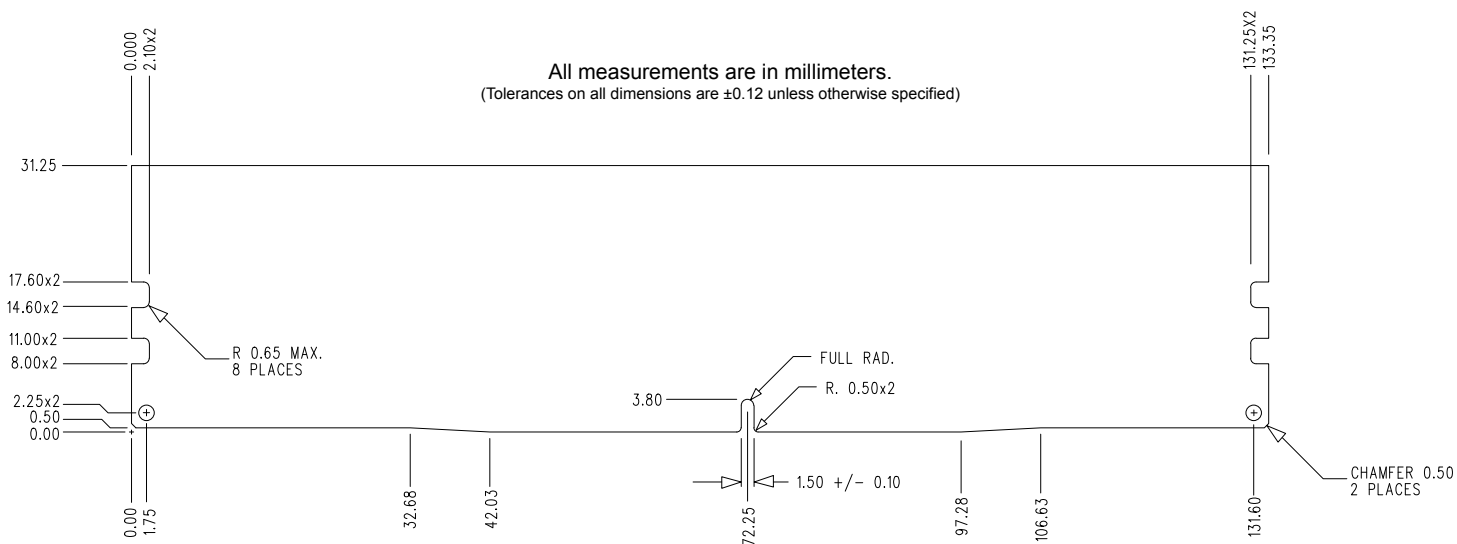
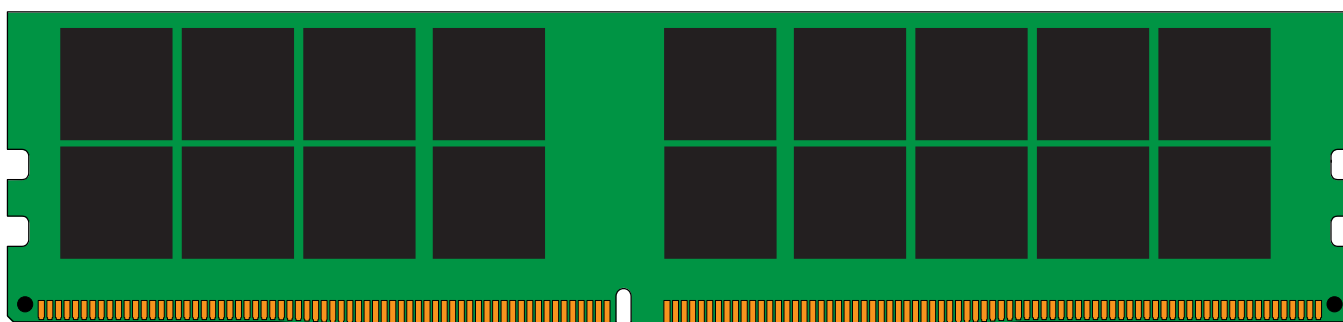
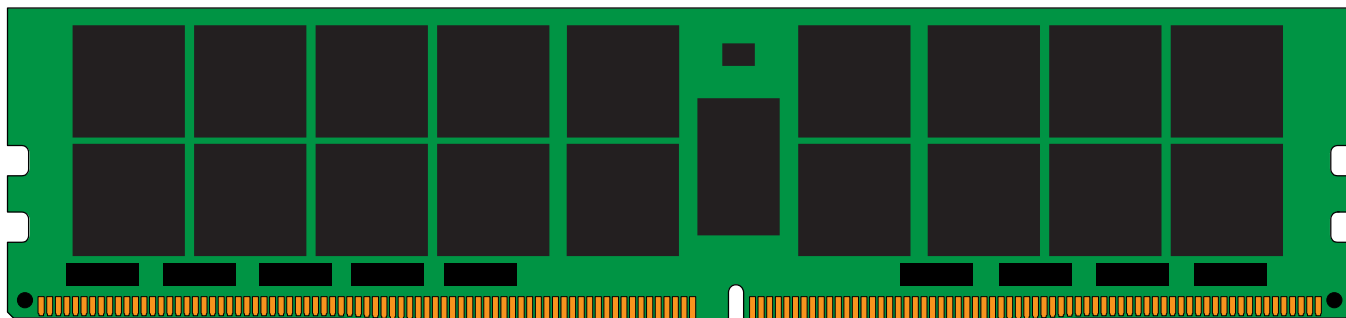

The product images shown are for illustration purposes only and may not be an exact representation of the product. Kingston reserves the right to change any information at anytime without notice.