

Memory Module Specifications

KSM26SES8/8HD

8GB 1Rx8 1G x 72-Bit PC4-2666

CL19 260-Pin ECC SODIMM

DESCRIPTION

Kingston's KSM26SES8/8HD is a 1G x 72-bit (8GB) DDR4-2666 CL19 SDRAM (Synchronous DRAM) w/ parity, 1Rx8, ECC, memory module, based on nine 1G x 8-bit FBGA components. The SPD is programmed to JEDEC standard latency DDR4-2666 timing of 19-19-19 at 1.2V. Each 260-pin SODIMM uses gold contact fingers. The electrical and mechanical specifications are as follows:

FEATURES

- Power Supply: VDD = 1.2V
- VDDQ = 1.2V
- VPP = 2.5V
- VDDSPD = 2.20V to 3.60V
- Functionality and operations comply with the DDR4 SDRAM datasheet
- 16 internal banks
- Bank Grouping is applied, and CAS to CAS latency (tCCD_L, tCCD_S) for the banks in the same or different bank group accesses are available
- Data transfer rates: PC4-2666, PC4-2400, PC4-2133, PC4-1866, PC4-1600
- Bi-Directional Differential Data Strobe
- 8 bit pre-fetch
- Burst Length (BL) switch on-the-fly BL8 or BC4(Burst Chop)
- Supports ECC error correction and detection
- On-Die Termination (ODT)
- Temperature sensor with integrated SPD
- This product is in compliance with the RoHS directive.
- Per DRAM Addressability is supported
- Internal Vref DQ level generation is available
- Write CRC is supported at all speed grades
- CA parity (Command/Address Parity) mode is supported
- RoHS Compliant and Halogen-Free

SPECIFICATIONS

CL(IDD)	19 cycles
Row Cycle Time (tRCmin)	45.75ns(min.)
Refresh to Active/Refresh Command Time (tRFCmin)	350ns(min.)
Row Active Time (tRASmin)	32ns(min.)
Maximum Operating Power	*
UL Rating	94 V - 0
Operating Temperature	0° C to +85° C
Storage Temperature	-55° C to +100° C

*See IDD Specifications (page 2)

Module Assembly

DRAM: HYNIX (D-DIE)

Continued >>

IDD Specifications

IDD		unit
Symbol	2666	
IDD0	292	mA
IDD0A	292	mA
IDD1	355	mA
IDD1A	377	mA
IDD2N	228	mA
IDD2NA	234	mA
IDD2NT	275	mA
IDD2NL	161	mA
IDD2NG	232	mA
IDD2ND	224	mA
IDD2NP	236	mA
IDD2P	153	mA
IDD2Q	210	mA
IDD3N	246	mA
IDD3NA	246	mA
IDD3P	189	mA
IDD4R	894	mA
IDD4RA	919	mA
IDD4RB	907	mA
IDD4W	889	mA
IDD4WA	914	mA
IDD4WB	806	mA
IDD4WC	855	mA
IDD4WP	1022	mA
IDD5B	1748	mA
IDD5F2	1250	mA
IDD5F4	1095	mA
IDD6N	169	mA
IDD6E	233	mA
IDD6R	109	mA
IDD6A	233	mA
IDD7	1152	mA
IDD8	88	mA

IPP		unit
Symbol	2666	
IPP0	46	mA
IPP1	53	mA
IPP2N	31	mA
IPP2P	28	mA
IPP3N	122	mA
IPP3P	120	mA
IPP4R	149	mA
IPP4W	148	mA
IPP5B	473	mA
IPP5F2	307	mA
IPP5F4	264	mA
IPP6N	46	mA
IPP6E	62	mA
IPP6R	37	mA
IPP6A	63	mA
IPP7	144	mA
IPP8	29	mA

MODULE DIMENSIONS

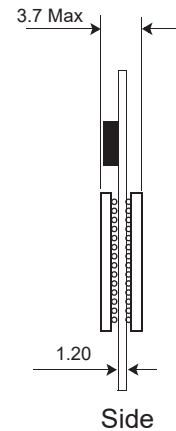
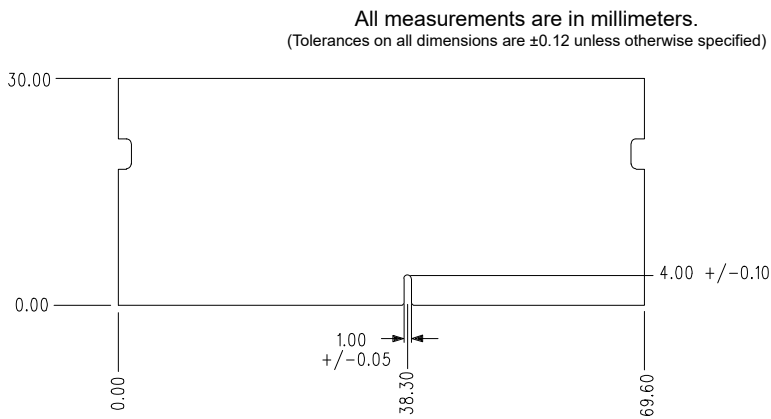
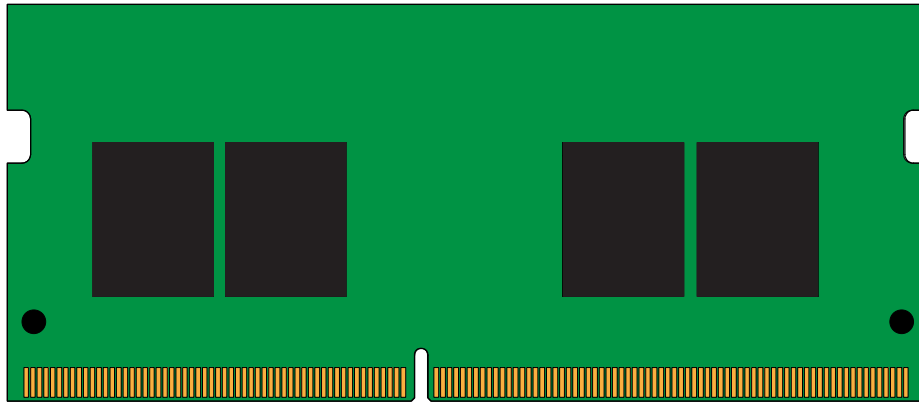
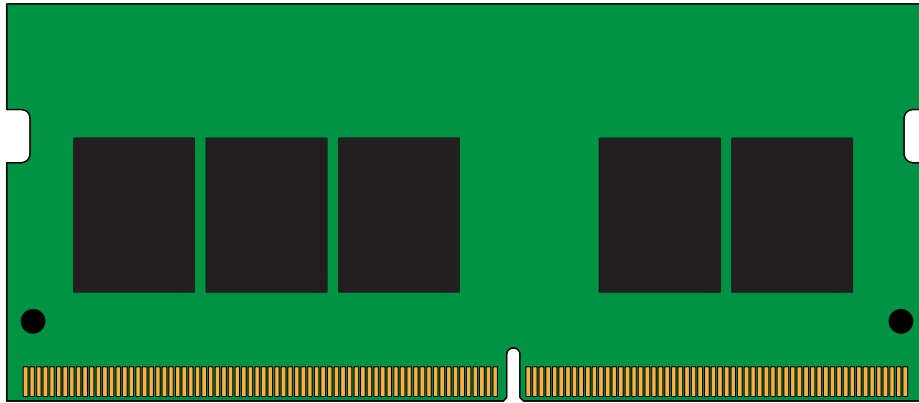

The product images shown are for illustration purposes only and may not be an exact representation of the product. Kingston reserves the right to change any information at anytime without notice.