

KVR800D2D4P6/8G
8GB 1024M x 72-Bit DDR2-800
CL6 Registered w/Parity 240-Pin DIMM

DESCRIPTION:

This document describes ValueRAM's 1024M x 72-bit (8GB) DDR2-800 CL6 SDRAM (Synchronous **DRAM**) "dual rank" Registered w/Parity memory module. The components on this module include thirty-six 512M x 4-bit DDR2-800 SDRAM in FBGA packages. This 240-pin DIMM uses gold contact fingers and requires +1.8V. The electrical and mechanical specifications are as follows:

FEATURES:

- | | |
|---|-------------------------------|
| ✓ Clock Cycle Time (tCK) CL=6 | 2.5ns (min.) / 8ns (max.) |
| ✓ Row Cycle Time (tRC) | 60ns (min.) |
| ✓ Refresh to Active/Refresh Command Time (tRFC) | 195ns |
| ✓ Row Active Time (tRAS) | 45ns (min.) / 70,000ns (max.) |
| ✓ Single Power Supply of | +1.8V (+/- .1V) |
| ✓ Power | 7.236 W (operating) |
| ✓ UL Rating | 94 V - 0 |

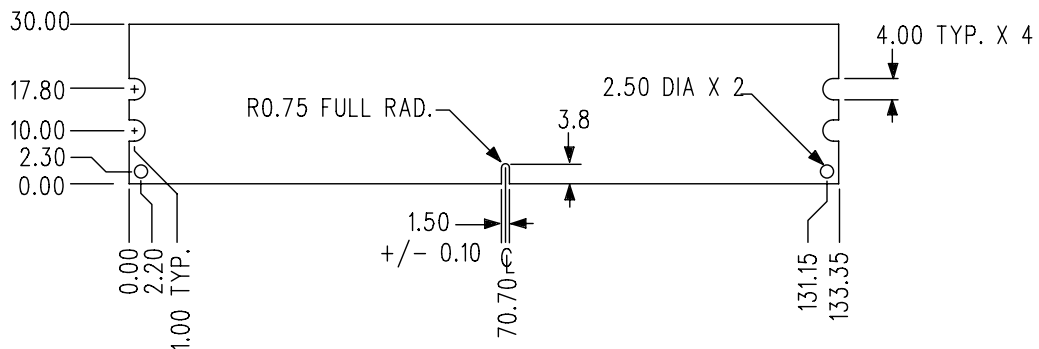
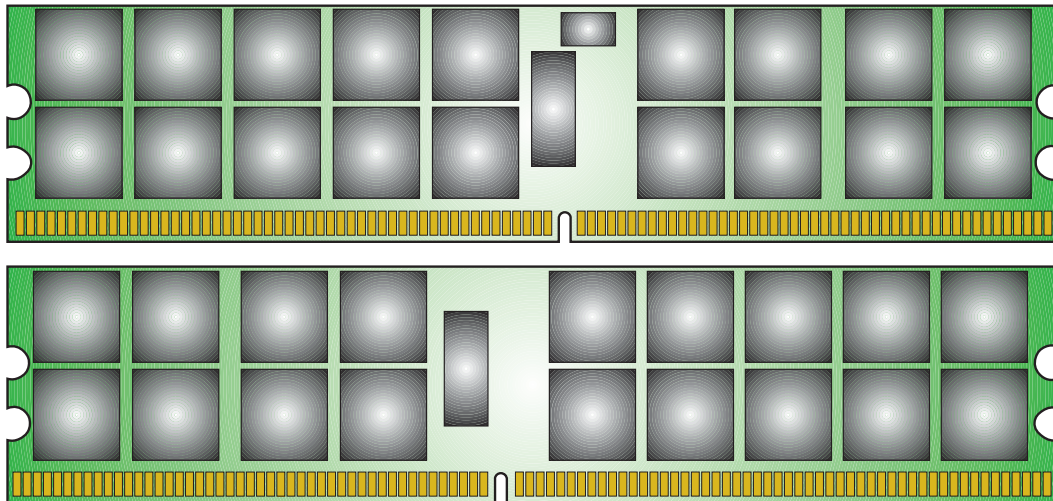

Figure 1: KVR800D2D4P6/8G 240-Pin DIMM